



173 Somerset Avenue, Yate, BS37 7SL

£385,000

Ground Floor

Approx. 56.3 sq. metres (606.0 sq. feet)

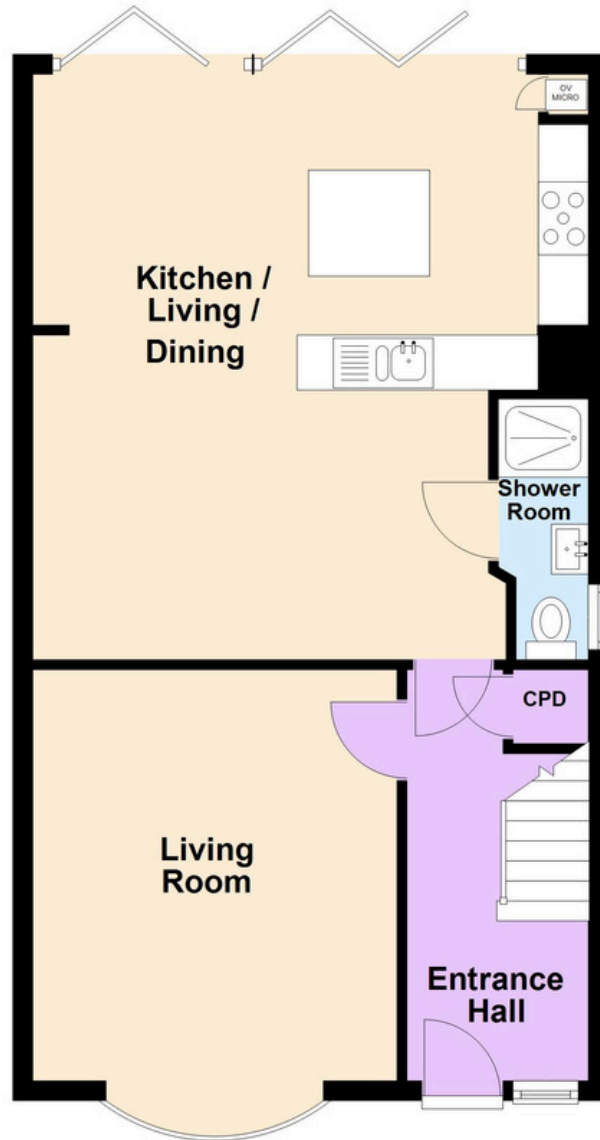

First Floor

Approx. 41.8 sq. metres (450.3 sq. feet)

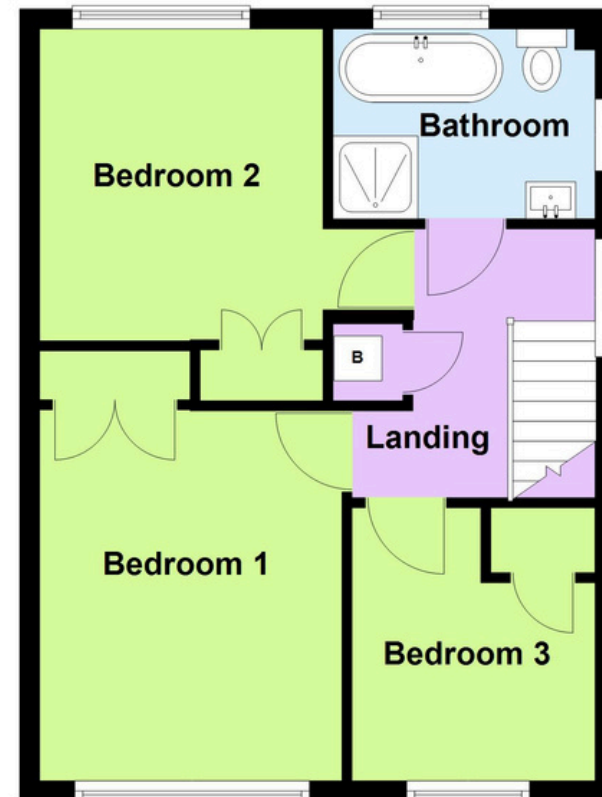

Total area: approx. 98.1 sq. metres (1056.4 sq. feet)

This plan is for illustrative purposes only. Whilst every care has been taken to ensure the accuracy of the floorplan, measurements, door/window positions and rooms are approximate and no responsibility is taken for any error/omissions
Plan produced using PlanUp.