



15 Turner Road, Yate, BS37 7EU

£350,000



## Ground Floor

Approx. 43.1 sq. metres (464.2 sq. feet)

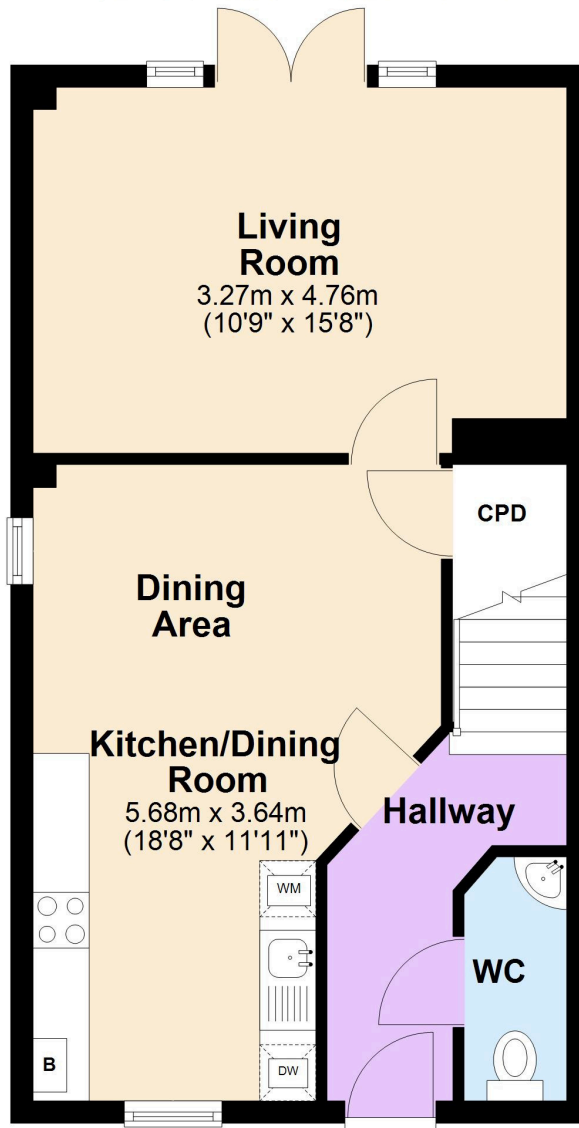

## First Floor

Approx. 43.1 sq. metres (464.2 sq. feet)

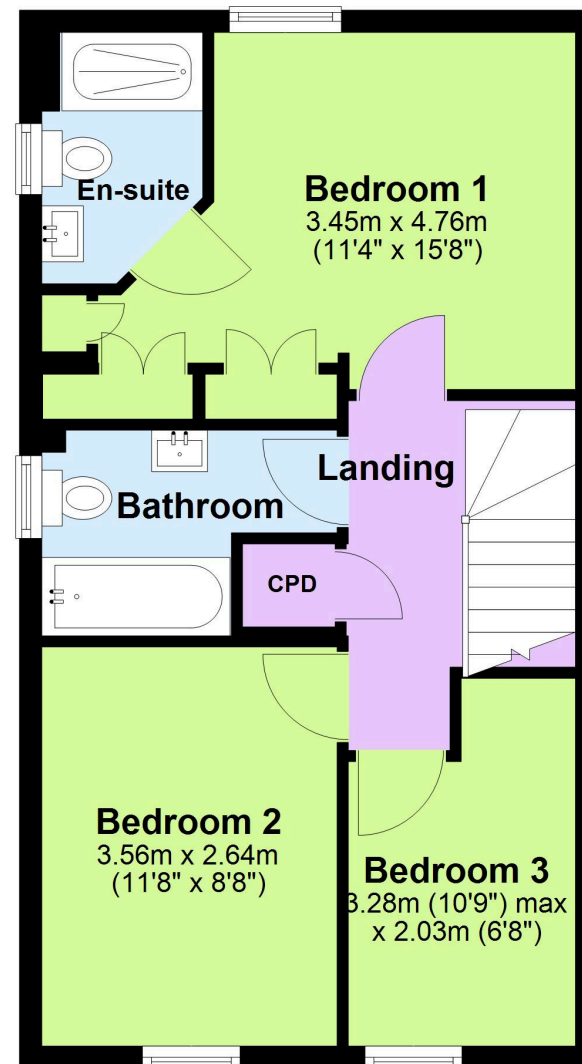

Total area: approx. 86.2 sq. metres (928.4 sq. feet)

This plan is for illustrative purposes only. Whilst every care has been taken to ensure the accuracy of the floorplan, measurements, door/window positions and rooms are approximate and no responsibility is taken for any error/omissions  
Plan produced using PlanUp.